

Welcome to our Onsen

We hope that you enjoy your onsen experience and your time in our hotel. This information sheet has been compiled to assist you in enjoying the Onsen experience.

The Onsen (Hot Spring) bathing area is open to the general public from 9:00am to 21:00pm daily. The closing time for public usage is 22:00pm with last entries at 21:00pm.

1. Remove your footwear at the entrance.
2. Undress and place your clothing and personal items including valubles in the lockers provided.
3. Leave your Bath Towel in the locker and take the smaller modesty towel with you into the bathing area.
4. Please ensure to lock all valubles in the lockers provided, ensure to take the key with you when entering the bath area.
5. Put your wet towels in the basket provided and ensure you have all of your valubles with you before you leave.

THE INSTRUCTIONS OF HOW TO ENJOY THE ONSEN EXPERIENCE ARE ON THE FOLLOWING PAGE

Lockers

Flooring is Bamboo

Please remove footwear upon entry to the bath area. Place footwear in the provided footwear shelving by the entrance.

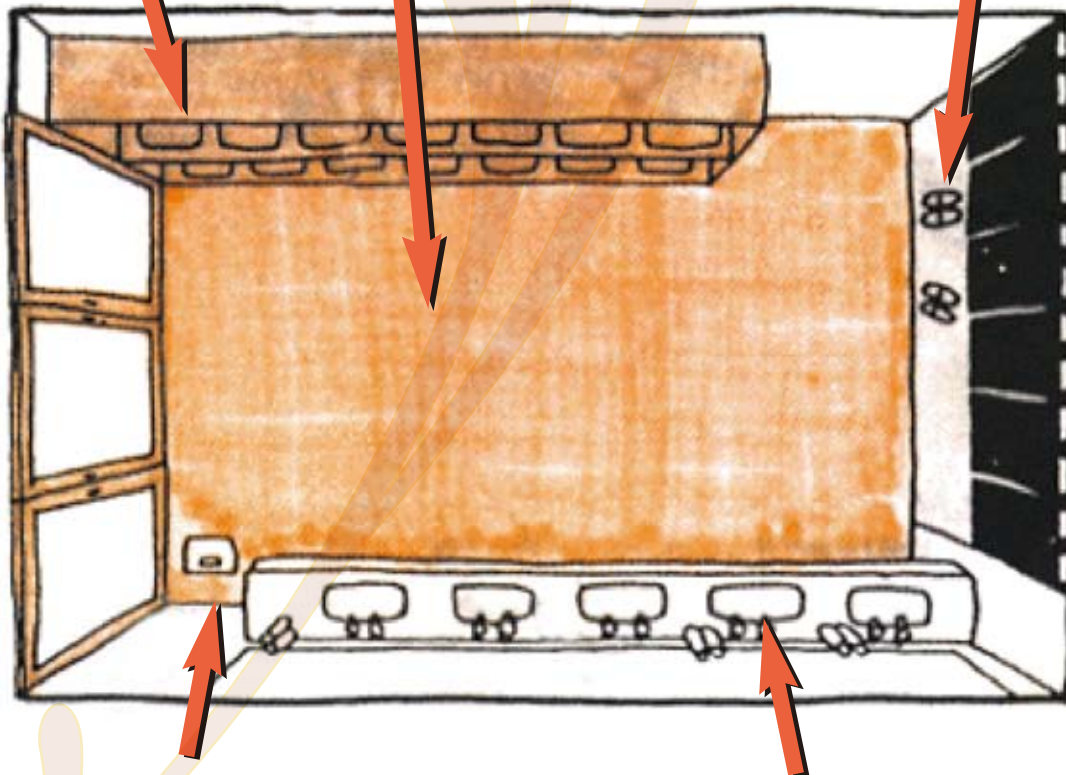

Body scales are provided near the entrance to the bathing area.

Please close the door when entering the bathing area

There are face towels and combs and toothbrushes proved in this area. Please dispose after using in the bins provided.

Dear Guests please note that the Slippers in the entrance way belong to In house guests and no shoes or slippers are worn in the changing area